

No	Réf	Qté	Désignation	Description
1	124624	1	Clapet HP	HP seat
2	127585	1	Siège	Crown
3	A02002	1	Aiguille	Pin
4	129121	1	Poussoir	Pin support
5	119159	1	Diaphragme	Diaphragm
6	129602	1	Ecrou chambre sèche Legend	Legend dry chamber screw
7	129606	1	Piston Legend	Legend Piston
8	127567	1	Ressort MP	IP spring
9	127565	1	Embase Ressort MP	Spring Pad
10	129126	1	Membrane	Diaphragm
11	127568	1	Rondelle	Washer
12	127566	1	Ecrou réglage MP	IP Adjusting screw
13	129209	1	Filtre Legend ACD	ACD Legend filter
14	129708	2	bouchon HP 7/16" Legend PVD	PVD Legend 7/16" HP plug
15	129707	3	Bouchon MP 3/8" Legend PVD	PVD Legend 3/8" IP plug
16	129701	1	Bouchon chambre sèche Legend PVD	PVD Legend dry chamber plug
17	129608	1	Bouchon ACD DIN	Din ACD Cap
18	129611	1	Rondelle chambre sèche Legend	Legend dry chamber washer
19	129609	1	Protecteur chambre sèche Legend	Legend dry chamber protector
20	129617	1	Sticker Legend encollé	Legend Sticker (with pasting)
21	129709	1	Bouchon Barillet PVD	PVD Counter balance plug
22	129204	1	Ressort ACD	ACD spring
23	122244	1	Ressort	Spring
24	124704	1	JT 1.9x7.2 EPDM 80ShA	OR 1.9x7.2 EPDM 80ShA
25	119129	1	Bague Anti Extrusion 1,35 x 3,56 NITRILE 90ShA	Anti Extrusion Washer 1,35 x 3,56 NITRILE 90ShA
26	124612	1	JT 1.78x2.9 EPDM 90ShA	OR 1.78x2.9 EPDM 90ShA
27	213714	1	JT 2x11 EPDM 80shA	OR 2x11 EPDM 80shA
28	129722	1	Volant DIN Legend PVD	PVD Legend DIN handwheel
29	129213	1	vis DIN ACD Legend	DIN screw ACD Legend
30	129706	1	Siège obturateur PVD	PVD Din shutter crown
31	129714	1	Nez Obturateur DIN PVD	PVD DIN Shutter Valve
32	124703	4	Bague	O-ring
33	124709	1	JT 2.7 x 10.5 85ShA	OR 2.7 x 10.5 85ShA
34	444243	1	JT 1.78x6.07 EPDM 80ShA	OR 1.78x6.07 EPDM 80ShA
35	473057	1	bague	O-ring
36	124701	2	Joint torique 1.78x8.74	O-ring 1.78x8.74
37	129702	1	Bague à Ailettes Legend PVD	PVD Legend Ring
38	129262	1	corps HP Legend PVD NV marqué	NV PVD Legend 1st stage with marking
39	129241	1	Raccord new ACD DIN	New ACD Din union

(A)

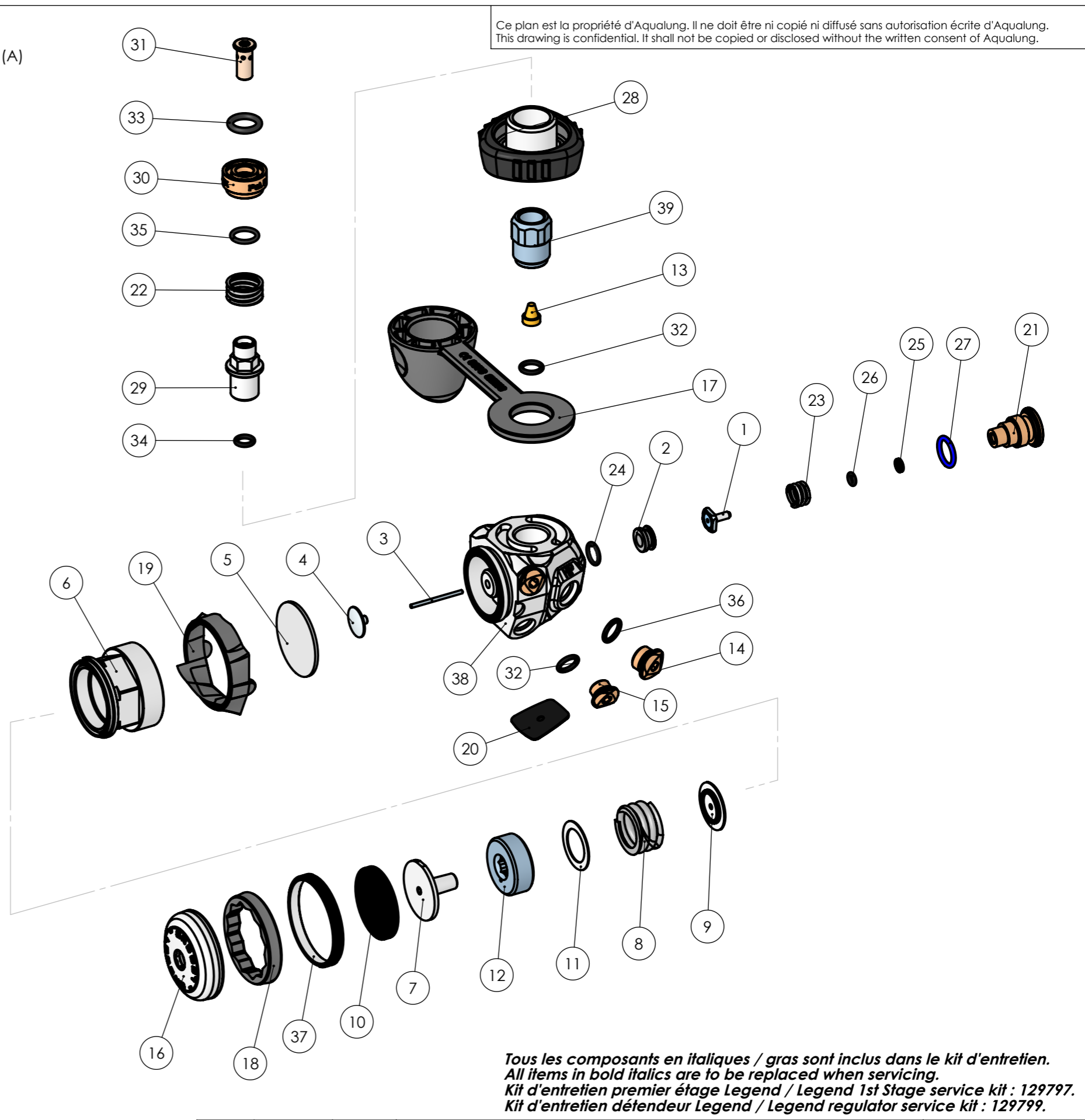

(B)

(B)

			Désignation	Premier étage Legend LUX ACD DIN	Visa: EG
			Description	Legend LUX DIN ACD first stage	1ère Avenue, 14ème rue - BP 148 06513 CARROS CEDEX FRANCE Tel: (33) 04 92 08 28 88 Fax: (33) 04 92 08 28 99
			Notice	-----	AQUA LUNG
			Date	23/06/11	
2112	20/09/12	B			129695 B
2063	08/12/11	A			
N°	Date Modif	Ind			