

No	Réf	Qté	Désignation	Description
1	124624	1	Clapet HP	HP seat
2	127585	1	Siège	Crown
3	A02002	1	Aiguille	Pin
4	129121	1	Poussoir	Pin support
5	119159	1	Diaphragme	Diaphragm
6	129602	1	Ecrou chambre sèche Legend	Legend dry chamber screw
7	129606	1	Piston Legend	Legend Piston
8	127567	1	Ressort MP	IP spring
9	127565	1	Embase Ressort MP	Spring Pad
10	129126	1	Membrane	Diaphragm
11	127568	1	Rondelle	Washer
12	127566	1	Ecrou réglage MP	IP Adjusting screw
13	129209	1	Filtre Legend ACD	ACD Legend filter
14	129613	2	bouchon HP 7/16" Legend	Legend 7/16" HP plug
15	129612	3	Bouchon MP 3/8" Legend	Legend 3/8" IP plug
16	129603	1	Bouchon chambre sèche Legend	Legend dry chamber plug
17	129607	1	Bouchon ACD étrier	Yoke ACD Cap
18	129611	1	Rondelle chambre sèche Legend	Legend dry chamber washer
19	129609	1	Protecteur chambre sèche Legend	Legend dry chamber protector
20	129617	1	Sticker Legend encollé	Legend Sticker (with pasting)
21	129604	1	Chambre de compensation Legend 2	Legend 2 Counter balance cylinder
22	129204	1	Ressort ACD	ACD spring
23	129205	1	Siège Obturateur Etrier	Yoke Shutter Crown
24	129207	1	Nez Obturateur Etrier	Yoke Shutter Valve
25	124611	1	Etrier 98 poli	Bright 98 yoke
26	129618	1	Vis d'étrier Legend 2	Legend 2 Yoke screw
27	122244	1	Ressort	Spring
28	124704	1	JT 1.9x7.2 EPDM 80ShA	OR 1.9x7.2 EPDM 80ShA
29	119129	1	Bague Anti Extrusion 1,35 x 3,56 NITRILE 90ShA	Anti Extrusion Washer 1,35 x 3,56 NITRILE 90ShA
30	124612	1	JT 1.78x2.9 EPDM 90ShA	OR 1.78x2.9 EPDM 90ShA
31	213714	1	JT 2x11 EPDM 80shA	OR 2x11 EPDM 80shA
32	124703	5	Bague	O-ring
33	473056	1	JT 1.78 x 5.28 EPDM 80ShA	O-ring 1.78 x 5.28 EPDM 80ShA
34	124701	2	Joint torique 1.78x8.74	O-ring 1.78x8.74
35	129623	1	Bague à Ailettes	Ring
36	129257	1	corps HP Legend NV marqué	Legend 1st stage NV with marking
37	129242	1	siège d'étrier Legend new ACD	New ACD Legend Yoke retainer

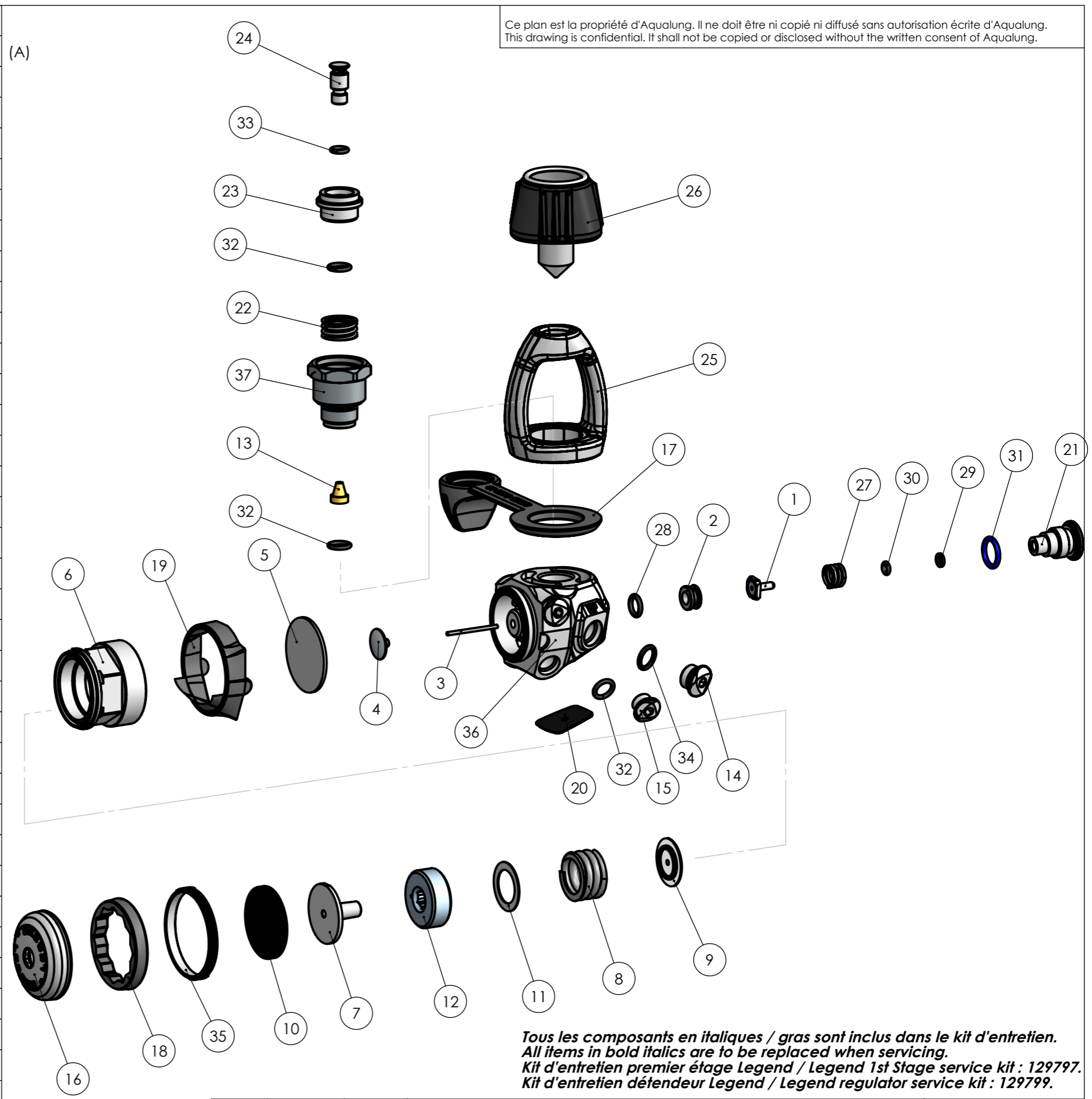

			Désignation	Premier étage Legend 2 étrier	Visa: TM
			Description	Legend 2 Yoke First Stage	1ère Avenue, 14ème rue - BP 148 06513 CARROS CEDEX FRANCE Tel: (33) 04 92 08 28 88 Fax: (33) 04 92 08 28 99
			Notice	-----	AQUA LUNG
			Date	18/01/2011	
2112	20/09/12	B			129605 B
2063	08/12/11	A			
N°	Date Modif	Ind			