

| No | Réf | Qté | Désignation | Description |
|-----------|---------------|----------|--------------------------------|-------------------------------|
| 1 | 129111 | 1 | Corps | Body |
| 2 | 129121 | 1 | Poussoir | Pin support |
| 3 | 119159 | 1 | Diaphragme | Diaphragm |
| 4 | 119143 | 1 | Rondelle | Washer |
| 5 | 124560 | 1 | Embase ressort | Spring pad |
| 6 | 129341 | 1 | Chambre sèche à ailettes | dry chamber with fins |
| 7 | 119156 | 1 | Ressort | Spring |
| 8 | H45097 | 1 | Rondelle | Washer |
| 9 | 122805 | 1 | Vis de réglage | Adjusting screw |
| 10 | 129123 | 1 | Piston | Piston |
| 11 | 129126 | 1 | Membrane | Diaphragm |
| 12 | 129349 | 1 | Bouchon Legend Glacia | Legend Glacia plug |
| 13 | 122224 | 1 | Siège | Crown |
| 14 | 124704 | 1 | JT 1.9x7.2 EPDM 80ShA | OR 1.9x7.2 EPDM 80ShA |
| 15 | A02002 | 1 | Aiguille | Pin |
| 16 | 124624 | 1 | Clapet HP | HP seat |
| 17 | 122244 | 1 | Ressort | Spring |
| 18 | 129120 | 1 | Bouchon | Plug |
| 19 | 119129 | 1 | Bague anti extrusion | Anti extrusion washer |
| 20 | 124612 | 1 | JT 1.78x2.9 EPDM 90ShA | OR 1.78x2.9 EPDM 90ShA |
| 21 | 213714 | 1 | JT 2x11 EPDM 80shA | OR 2x11 EPDM 80shA |
| 22 | 129112 | 1 | Protecteur | Housing |
| 23 | 129119 | 3 | Bouchon MP | IP plug |
| 24 | 129118 | 2 | Bouchon HP | HP plug |
| 25 | 124701 | 2 | Joint torique 1.78x8.74 | O-ring 1.78x8.74 |
| 26 | 124703 | 5 | Bague | O-ring |
| 27 | 124611 | 1 | Etrier chromé brillant | Bright plated yoke |
| 28 | 124148 | 1 | Vis d'etrier | Yoke screw |
| 29 | 129205 | 1 | Siège Obturateur Etrier | Yoke Shutter Crown |
| 30 | 129207 | 1 | Nez Obturateur Etrier | Yoke Shutter Valve |
| 31 | 473056 | 1 | Bague | O-ring |
| 32 | 129204 | 1 | Ressort ACD | ACD spring |
| 33 | 129212 | 1 | siège d'étrier Legend ACD | ACD Legend Yoke retainer |
| 34 | 129209 | 1 | Filtre Legend ACD | ACD Legend filter |
| 35 | 124555 | 1 | Bouchon d'etrier | Dust cap |

Ce plan est la propriété d'Aqualung. Il ne doit être ni copié ni diffusé sans autorisation écrite d'Aqualung.
This drawing is confidential. It shall not be copied or disclosed without the written consent of Aqualung.

Les composants notés en gras sont inclus dans le kit d'entretien
Part numbers in bold are included in the service kit

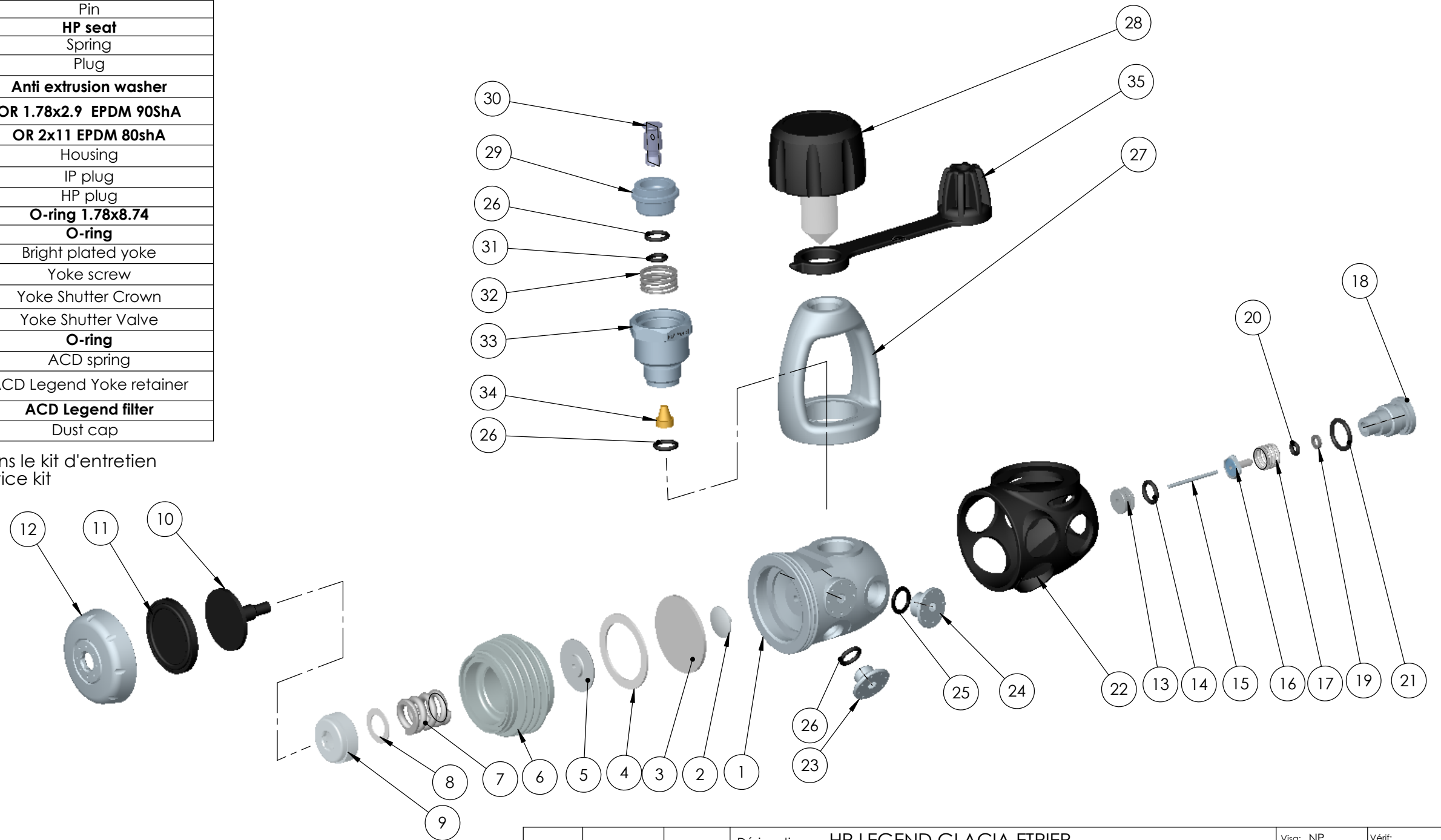

| | | | | | | |
|----|------------|-----|-------------|-------------------------|--|--------|
| | | | Désignation | HP LEGEND GLACIA ETRIER | Viso: NP | Vérif: |
| | | | Description | LEGEND GLACIA 1st STAGE | 1ère Avenue, 14ème rue - BP 148 06513 CARROS CEDEX FRANCE Tel: (33) 04 92 08 28 88 Fax: (33) 04 92 08 28 99 | |
| | | | Notice | ----- | | |
| | | | Date | 30/05/2006 | | |
| N° | Date Modif | Ind | | | | 129346 |